



~AN NGC STANDARD FLOWER SHOW~

The 50th Redbud District Standard Flower Show

~PRESENTED BY REDBUD DISTRICT VII~

In cooperation with

Callanwolde Fine Arts Center
980 Briarcliff Road, NE
Atlanta, Georgia 30306
404-872-5338

Wednesday, September 20, 2023 from 1:00 p.m. – 7:00 p.m.

Thursday, September 21, 2023 from 10:00 a.m. – 5:00 p.m.

~Open and Free to the Public~

Member of National Garden Clubs, Inc., Deep South Garden Clubs, Inc.,
The Garden Club of Georgia, Inc., Redbud District VII, and
The DeKalb County Federation of Garden Clubs, Inc.



Cheers to 50 Years! This year marks the 50th anniversary of Redbud District's Standard Flower Show. Daisy has been featured in many of these shows, so we celebrate her with *Decades of Daisy*. There are many *Milestones and Memories*, and *Daisy Says, Now Is The Time... for Celebrations*. We welcome you to join the fun and *Mountain of Memories* as we take a delightful tour through the many years that Daisy has *Bewitched* us, taken us 'Round the *Mountain*, shown her patriotism by *Saluting America*, *Rocked the Mountain*, shared her *Cookin'* and *Driven* her way into our hearts. Come see what paths Daisy will travel this year on her nostalgic tour as we relive *The Best of Daisy!* Many previous show titles, as well as Division, Section and Class titles have been incorporated into this 50th Show Schedule. It will be a trip down memory lane for Daisy. *Decades of Daisy* is a compilation of titles found in Redbud schedules from 1972-2022, and the years are noted in parentheses following the titles in this schedule. The first forty-eight shows were held at Stone Mountain Park (Stone Mountain, Ga.) and the two most recent at Callanwolde Fine Arts Center (Atlanta, Ga.). *Daisy Through the Ages* has been portrayed as a sophisticated Southern *Lady*, a strong woman in *Daisy Fabulous at Forty*, an environmental activist in *Going Green Daisy Style* and always an avid gardener. As we take a *Stroll Through Daisy's Garden*, we are greeted by trees, *The Stewards of the Garden*, flanking the entry. Statuary and *Sculptural Forms* dot the garden. Daisy's garden can be described as an amazing *Tapestry of Color* and a *Fusion of Green*. Flowering perennials put on a *Repeat Performance* with their showy flowers. And many *Savory Delights* can be found in the edible *Victory Garden*. Daisy has shown her artistic side by dabbling in the arts in *Daisy Digs Art* and *Dancing 'Round the World*. *Daisy Delights in Show and Tell*, so she *Tells Her Story*, but *Time Flies*, so let the *Fun Times* begin.



Table of Contents

Title Page	1
Show Theme	2
Table of Contents	3
Show Committee	4
General Rules	7
Awards and Ribbons	9
Division I, Horticulture Rules	12
Division I, Sample Horticulture Entry Card	15
Division I, Horticulture Classes	16
Division II, Design Rules	21
Division II, Design Scale of Points	24
Division II, Design Classes	25
Division III, Education Rules	28
Division III, Education Scale of Points	29
Division III, Education Exhibits	30
Division IV, Youth Design Rules, Section A	31
Division IV, Youth Design Classes, Section A	32
Division IV, Sponsored Group Design Rules, Section B	33
Division IV, Sponsored Group Design Classes, Section B	34
Floor Plan.....	35
Note of Appreciation	36



Show Committee

REDBUD DISTRICT DIRECTOR

Kim Fair
(Smoke Rise Morning Glories GC)

c. 404-384-7851
nevakim@yahoo.com

SHOW CHAIRMAN

Joy Zaidan, Chairman
4986 Chedworth Drive, Smoke Rise, GA 30087
(Smoke Rise Morning Glories GC, Designers Club)

c. 404-735-9379 h. 770-493-8475
joyzaidan4986@gmail.com

SHOW CO-CHAIRMAN

Gale Thomas, Co-Chairman
1301 Saxony Dr. SE, Conyers, GA 30013
(Conyers & Stonecrest GCs, Designers Club)

c. 404-790-7101
galedthomas@gmail.com

AWARDS CHAIRMEN

Rigby Duncan, Co-Chairman
(Hunting Hill GC)

c. 678-644-9502 h. 404-321-1733
rigbyduncan113@gmail.com

Bettye Trankina, Co-Chairman
(Designers Club)

h. 770-508-5222 c. 770-410-5819
bhtrankina@gmail.com

CLERKS CHAIRMAN

Ann Purr
(Mountain Mums GC)

c. 678-523-8146 h. 770-921-9070
a.purr@comcast.net

COVER DESIGN

Joy Zaidan
(Smoke Rise Morning Glories GC, Designers Club)

h. 770-493-8475
joyzaidan4986@gmail.com

DESIGN CLASSIFICATION/CONSULTANTS

Dian Goldwire (Section A, Classes 1-3)
(Pine Needle GC)

c. 706-957-4217
dgoldwire813@gmail.com

Bettye Trankina (Section B, Classes 4-6)
(Designers Club)

c. 770-508-5222 h. 770-410-5819
bhtrankina@gmail.com

Janet McGinnis (Section C, Classes 7-10)
(Smoke Rise Morning Glories GC, Designers Club)

c. 404-326-0530 h. 770-939-8878
jmcgi@bellsouth.net

DESIGN ENTRIES CHAIRMAN

Diane Hunter
(Breckenridge Garden Arts I GC, Designers Club)

c. 404-992-7381
drmchunter@yahoo.com

EDUCATION CHAIRMAN

Gale Thomas
(Conyers & Stonecrest GCs, Designers Club)

c. 404-790-7101
galedthomas@gmail.com

FINANCE CHAIRMAN

Rigby Duncan
(Hunting Hill GC)

c. 678-644-9502 h. 404-321-1733
rigbyduncan113@gmail.com

HORTICULTURE CLASSIFICATION CHAIRMEN

Sandy Reed, Chairman
(Shenandoah Rose GC)

c. 404-772-2854
sandyreed17@gmail.com

Lynn Malone, Co-Chairman
(Mountain Mums GC)

c. 678-471-2049 h. 770-934-5954
malone.lynn80@gmail.com

HORTICULTURE PLACEMENT CHAIRMEN

Quill Duncan, Chairman
(Smoke Rise Morning Glories GC)

h. 770-414-4766
quillduncan@msn.com

Bonnie Pennington, Co-Chairman
(Smoke Rise Morning Glories GC)

c. 404-803-6867 h. 770-469-2304
bonniepennington@comcast.net

HOSTESS CHAIRMAN

Ellen Nichol, Chairman
(Creative Study)

c. 770-845-2387
enichol482@gmail.com

JUDGES CHAIRMAN

Susan Turner
3380 Glencree NW, Conyers, GA 30012
(Conyers GC, Designers Club)

h. 770-922-4411 c.404-502-8147
glencree@bellsouth.net

JUDGES HOSPITALITY CHAIRMAN

Peggy Burgess
(Avondale Estates GC)

c. 404-992-7601
peggyburgess1969@gmail.com

LIAISON TO CALLANWOLDE

Ann Purr
(Mountain Mums GC)

c. 678-523-8146 h. 770-921-9070
a.purr@comcast.net

PHOTOGRAPHY CHAIRMAN

Dianne Smith
(Shenandoah Rose GC)

h. 678-571-8510
sdmsmith@mindspring.com

PRINTING CHAIRMEN

Rigby and Jack Duncan
(Hunting Hill GC)

c. 678-644-9502 h. 404-321-1733
rigbyduncan113@gmail.com

PROPERTIES CHAIRMEN

Glennolyn Hallman, Chairman
(Smoke Rise Morning Glories GC)

c. 404-630-5539 h. 770-491-7398
gkh44@aol.com

Quill Duncan, Co-Chairman
(Smoke Rise Morning Glories GC)

c. 404-512-9849 h. 770-414-4766
quillduncan@msn.com

PUBLICITY CHAIRMAN

Quill Duncan
(Smoke Rise Morning Glories GC)

c. 404-512-9849 h. 770-414-4766
quillduncan@msn.com

RIBBON CUTTING CEREMONY COORDINATOR

Kim Fair
(Smoke Rise Morning Glories GC)

c. 404-384-7851
nevakim@yahoo.com

SCHEDULE COMMITTEE

Joy Zaidan, Chairman
(Smoke Rise Morning Glories GC, Designers Club)

c. 404-735-9379 h. 770-493-8475
joyzaidan4986@gmail.com

Gale Thomas
(Conyers & Stonecrest GCs, Designers Club)

c. 404-790-7101
galedthomas@gmail.com

Janet McGinnis
(Smoke Rise Morning Glories GC, Designers Club)

c. 404-326-0530 h. 770-939-8878
jmcgi@bellsouth.net

Susan Turner
(Conyers GC, Designers Club)

c. 404-502-8147 h. 770-922-4411
glencree@bellsouth.net

SPONSORED GROUPS CHAIRMAN

Gale Thomas, Chairman
(Conyers & Stonecrest GCs, Designers Club)

c. 404-790-7101
galedthomas@gmail.com

STAGING AND SIGNAGE CHAIRMEN

Janet McGinnis, Chairman
(Smoke Rise Morning Glories GC, Designers Club)

c. 404-326-0530 h. 770-939-8878
jmcgi@bellsouth.net

Melodie Janin, Co-Chairman
(Smoke Rise Morning Glories GC)

c. 678-633-0219
melodiejanin@yahoo.com

WORKERS HOSPITALITY CHAIRMAN

Kathy Kingsbury
(Avon GC)

c. 404-316-5180
CSKNO1@aol.com

YOUTH CHAIRMEN

Susan Turner, Chairman
(Conyers GC, Designers Club)

c. 404-502-8147 h. 770-922-4411
glencree@bellsouth.net

Melodie Janin, Co-Chairman
(Smoke Rise Morning Glories GC)

c. 678-633-0219
melodiejanin@yahoo.com



General Rules

1. This flower show conforms to the standards established by National Garden Clubs, Inc. (NGC). The *HANDBOOK FOR FLOWER SHOWS (HB)*, revised 2017-2nd Edition, with revisions found in *The National Gardener* magazine (*TNG*) online at www.gardenclub.org, is the authority for all issues not covered by this schedule, which is the Law of the Show.
2. Any amateur gardener may enter the Horticulture Division and is encouraged to do so. The Design and Education Divisions are open to members of an organized Garden Club, Judges Study Club or Council that is a member of The Garden Club of Georgia, Inc. All Student Exhibitors who have successfully completed two courses of Flower Show School, Student Judges who have successfully completed three courses of Flower Show School, all levels of Accredited Judges needing exhibiting credit, and Subscribing Members of GCG are invited to enter the Design, Horticulture and Education Divisions. The Youth Design Division IV, Section A is open to youth pre-school through eighteen years of age. Members of the Olivia Haydel Senior Center in Conyers are invited to enter designs in the Sponsored Groups Design Section of Division IV, Section B.
3. Horticulture Entry Cards, available August 1, 2023, may be obtained from The DeKalb Federation Garden Center (404-872-5730) or by contacting Sandy Reed, Horticulture Classification Chairman (404-772-2854; sandyreed17@gmail.com). An NGC horticulture entry card, filled out on **both** top and bottom sections, **must** accompany each horticulture entry. Exhibitors are requested to legibly complete entry cards in advance **using pencil to fill in Section, Class and Botanical Name or Currently Accepted Scientific Identification**. Genus, specific epithet (species) and variety names are underlined when handwritten and *italicized* when mechanically printed. Pencil or waterproof ink may be used to complete the rest of the card. Computer-generated address labels may be used if waterproof.
4. Horticulture entries **must** be submitted on Tuesday, September 19, 2023, from 1:00 p.m. to 6:00 p.m. in the Courtyard kitchen of the Callanwolde Fine Arts Center, 980 Briarcliff Rd., Atlanta. Only cut perishable blooms and entries of exhibitors living outside Metro Atlanta will be accepted on Wednesday, September 20, 2023, from 8:00 a.m. to 9:00 a.m. Design Division entries may be made at Callanwolde in the Courtyard Room during any of the above hours. Education, Youth and Sponsored Groups exhibits may be entered in the Dining Room at Callanwolde during any of the above hours. Exhibits **must** be removed from Callanwolde on Thursday, September 21, 2023, between the hours of 5:00 p.m. and 5:30 p.m. and **may not** be removed before 5:00 p.m.
5. Each exhibitor is limited to one entry per class, except in the Horticulture Division.
6. The use of plants on the State Conservation List is strictly **prohibited**. These threatened and endangered plants can be located at www.georgiabiodiversity.org/portal/table/plants and

www.plants.usda.gov/threat. Other native plant material may be exhibited in the Horticulture Division provided it is grown by the exhibitor. It may also be exhibited in the Design, Education and Youth/Sponsored Groups Divisions, if grown by the exhibitor or obtained in a legal manner and labeled with the correct botanical name or its currently accepted scientific identification. Plants on the Invasive and Noxious Plant List are **not** permitted in the Horticulture and Design Divisions (www.invasiveplantatlas.org/subject.html?sub=3057 or www.gaepc.org/list/). The primary horticulture nomenclature resource of NGC is www.plantsoftheworldonline.org.

7. There must be an emphasis on FRESH plant material. **No** artificial plant material is permitted in any exhibit in any division. Exception: Artificial plant material may be used in staging (*HB*, p.3, B3).
8. Redbud District and Callanwolde Fine Arts Center will strive to assure the safety of all items after arrival and placement but are not responsible for any loss or damage to exhibits or personal property.
9. The Classification Chairman for each division checks exhibits for conformity to the schedule prior to judging. **Final determination for conformance is the judge's responsibility.**
10. Judges are requested to leave written comments on exhibits in Division II, Design; Division III, Education; Division IV, Section A, Youth Design and Section B, Sponsored Groups Design. Exact scores and/or 95+ must **not** be written on blue ribbon-winning cards until Section and Division judging has been completed and all competitive awards placed. Sponsored Groups are not eligible for NGC Top Exhibitor Awards.
11. The decisions of the judges are final. Awards may be withheld if not merited.
12. **The entry cards of all blue ribbon-winning exhibits and Top Exhibitor Award rosettes must be signed and dated by one NGC Accredited Judge on the judging panel. All non-blue ribbon exhibits scoring 90+ points must be designated on the entry card and signed and dated by an NGC Accredited Judge on the judging panel. All other entry cards are to be marked with a check by a member of the judging panel to indicate that the exhibit has been judged.**
13. Each exhibit in competition for ribbons and NGC Top Exhibitor Awards **must** be the work of one individual.
14. Designs and/or Educational exhibits **must not** have been exhibited in previous flower shows or any other venue for judging and point scoring by the NGC Standard System of Awarding.
15. Judging will begin at 10:00 a.m. on Wednesday, September 20, 2023. The General Chairman and the Classification Chairmen for each division are available during judging for possible consultations. They, along with the judges, judges' chairman, clerks and clerks' chairman, are the only personnel allowed on the floor during judging. The photographer may take photos before and after the judging, but not during the judging. **Photographs may be taken for personal use but may not be posted on social media without consent of the exhibitor.** Judges are asked to remain in the Great Hall until all Top awards have been placed.
16. The Flower Show opens to the public at 1:00 p.m. on Wednesday, September 20, 2023.

17. Tables in Division I, Horticulture, and in Division IV, Youth/Sponsored Groups Design, will be skirted by the Show Committee in gray with a white topper bordered with gold dots. Tables in Division III, Education, will be skirted in gray with a gray topper. Exhibitor has the option of a white topper bordered with gold dots.



The NGC Standard System of Awarding is used in all divisions (*HB* pp. 5, 39-48).

1. Only one first place (blue) ribbon per class or subclass; must score 90 points or more.
2. Only one second place (red) ribbon per class or subclass; must score 85 points or more.
3. Only one third place (yellow) ribbon per class or subclass; must score 80 points or more.
4. One or more Honorable Mention (white) ribbons as merited; must score 75 points or more.

NGC Top Exhibitor Award Rosettes may be given to the blue ribbon-winning exhibits in designated classes which meet the following requirements: Design, Horticulture and Education exhibits must be blue ribbon winners scoring 95 or above and must have met other requirements attendant to that Top Award (*HB*, pp. 39-48). To receive an NGC Top Exhibitor Award, the horticulture specimen **must** be identified with the correct binomial (botanical) name or its currently accepted scientific identification. **To be eligible for an NGC Top Exhibitor Award in the Youth Design Division, Section A, an exhibit must have been the highest scoring blue ribbon-winning exhibit scoring 90 or above in each age category.**

Division I, NGC Horticulture Awards

The **NGC AWARD OF HORTICULTURAL EXCELLENCE** (*HB* p. 40), a rosette of green, orange and blue ribbons: one is offered to the highest scoring 95+ blue ribbon winning exhibit and correctly named exhibit entered by an individual in the entire Horticulture Division I, Classes 1-77 (with a minimum of 5 classes and 20 exhibits required). The Award of Horticulture Excellence is **not** limited to exhibits having received a Section Top Exhibitor Award. It is also available to all first-place blue ribbons scoring 95 or above that are **not** in sections designated for a Section Top Exhibitor Award.

The **NGC AWARD OF MERIT** (*HB* p. 41, 2), a rosette of orange ribbons: nine are offered, each to the highest scoring 95+ blue-ribbon winner and correctly named exhibit of non-woody/non-arboreal, cut specimens in the following nine Sections:

Section C – Ferns, true

Classes 8 - 17

Section D - <i>Hosta</i>	Classes 18 - 21
Section F - <i>Rosa</i> (rose)	Classes 30 - 33
Section H - Flowering Annuals	Classes 38 - 44
Section I - Foliage Annuals	Classes 45 - 48
Section J - Flowering Perennials	Classes 49 - 55
Section L - Flowering Bulbs, Corms, Tubers, Rhizomes	Classes 63 - 66
Section M - Foliage Bulbs, Corms, Tubers, Rhizomes	Classes 67 - 70
Section O - Fruits and Vegetables, edible produce	Classes 74 - 77

The **NGC COLLECTOR'S SHOWCASE AWARD** (*HB* p. 41, 3), a rosette of brown and green ribbons: one is offered to the highest scoring 95+ blue ribbon winner and correctly named exhibit in the following Section:

Section G - Collections, Foliage Cut Specimens (non-arboreal)	Classes 34 - 37
---	-----------------

The **NGC ARBOREAL AWARD** (*HB* p. 40, II, C,1), a rosette of two shades of green ribbons: two are offered, each to the highest scoring 95+ blue ribbon winner and correctly named exhibit in the following two Sections:

Section A - Shrubs	Classes 1 - 4
Section B - Trees	Classes 5 - 7

Division II, NGC Design Awards

The **NGC AWARD OF DESIGN EXCELLENCE** (*HB* p.42, III, B, 1), a rosette of gold ribbons: one is offered to the highest scoring 95+ blue ribbon winning exhibit entered by an individual in the entire Design Division II, Classes 1-10. In sections where NGC Top Exhibitor Awards have been placed, only those winners are eligible for consideration from those sections for the Award of Design Excellence. A Standard Flower Show must include a minimum of 5 design classes with 4 exhibits per class.

The **NGC PETITE AWARD** (*HB* p. 43, III, C, 3), a small rosette of blue and white ribbons: one is offered to the highest scoring 95+ blue ribbon-winning petite exhibit, either Creative or Traditional, in Division II, Section A, Classes 1-3, with a minimum of four exhibits in each class.

The **NGC DESIGNER'S CHOICE AWARD** (*HB* p. 42, III, C, 2), a rosette of purple ribbons: one is offered to the highest scoring 95+ blue ribbon-winning exhibit in Division II, Section B, Classes 4-6, with a minimum of four exhibits in each class; and one is offered to the highest scoring blue ribbon-winning exhibit in Division II, Section C, Classes 7-10, with a minimum of four exhibits in each class.

Division III, NGC Educational Award

The **NGC EDUCATIONAL AWARD** (HB pp. 43-44, V), a rosette of brown and white ribbons: one is offered to the highest scoring 95+ blue ribbon-winning exhibit in Division III, Education, Section A, Class 1, Exhibits 1, 2 and 3.

Division IV, NGC Youth Design Awards

The **NGC YOUTH AWARD** (HB p. 44, VI), a rosette of red, white and blue ribbons: is offered to the highest scoring exhibit scoring **90 or above** in the Youth Division IV, Section A, Design, Classes 1-3. A total of 3 are offered in the Youth Division. One is offered in Design in each of the following age categories:

Juniors: pre-school through age seven, or elementary grades

Intermediates: ages eight through twelve, or middle school grades

High School: ages thirteen through eighteen, or junior/senior high school grades

NGC Additional Awards

The **NGC SWEEPSTAKES AWARD** (HB p. 46, VIII, D), a rosette of green and white ribbons: one is offered to the **INDIVIDUAL** winning the most blue ribbons in Division I, Horticulture, Classes 1-77. In the event of a tie, red, then yellow, then white ribbons will be counted.

Local Awards

One **BLUE RIBBON SWEEPSTAKES AWARD**, a cash prize of \$50.00, will be given to the **CLUB** winning the most blue ribbons in the entire Show (including Division I, Horticulture; Division II, Design and Division III, Education).

One **REDBUD DISTRICT ELINORE WILSON TROPHY AWARD**, a silver bowl, will be presented to the winner of the NGC Award of Horticultural Excellence (Division I, Classes 1-77).

One **HALLIE BROWN MEMORIAL TROPHY AWARD**, a silver bowl, will be presented to the winner of the NGC Sweepstakes Award in Division I, Horticulture, Classes 1-77.

One **MICKIE HOLTON INSPIRATIONAL AWARD** will be presented to the design in Division II, Classes 1-10 that inspires the viewer through its unique expression of the class title. Blue, red, yellow or white ribbons may be considered by the judges, and the winner will be awarded a crystal candleholder.

Sponsored Group Awards

Three **BEST IN CLASS SPONSORED GROUP DESIGN AWARDS** and a cash award of \$20.00 will be offered to each Class winner scoring 90+ in the Sponsored Group Design, Division IV, Section B. One will be given to the highest scoring design in Class 4, one in Class 5 and one in Class 6.

Hort. Rules, Division I

1. All horticulture specimens **must** be FRESH plant material grown by the exhibitor and must be well-groomed, clean, of show quality, and may not be altered by application (treatment) of oil, commercial “shine” products, etc. that change the natural appearance. No wiring of specimens is permitted. NGC Exhibit Policies are listed in the *HB*, Chapter 6, p. 55. Exhibiting of plants on the State Conservation and Invasive/Noxious Plant Lists is **prohibited** in this Division (refer to pp. 7-8, rule #6 in this schedule).
2. Only foliage and/or flowers naturally grown and still attached to the specimen are permitted in the Flower Show. Unattached foliage is never included with a cut bloom specimen.
3. All plant material must have been in the possession of the exhibitor the appropriate number of days as listed below:

Type of Plant Material	Length of Possession
Combination Plantings except troughs	6 weeks growing together
Annuals	90 days EXCEPTION: no minimum for early maturing seeds and/or transplants
Bulbs	90 days EXCEPTION: no minimum for forced bulbs/corms/tubers/rhizomes such as <i>Hippeastrum</i> (amaryllis), paperwhite <i>Narcissus</i> , hyacinths, etc.
Houseplants	90 days
Perennials (Herbaceous)	90 days
Vegetables and Fruits	90 days EXCEPTION: no minimum for early maturing crops such as lettuce, radishes, watercress, etc.
Arboreals (Woody Ornamentals)	6 months
Troughs	6 months growing together

4. Exhibitor may make more than one entry per class if each entry is a different species, cultivar, variety, color or type.
5. The rules for a single species cut specimen are listed in the *HB*, pp. 55-61, or its supplement *Horticulture Exhibiting and Judging*. Each entry submitted must be one stem per cut specimen. Cut specimens should **not** have foliage below the water line. **Exception:** *Gladiolus*, at least two leaves.
6. To receive an NGC Top Exhibitor Award, the exhibitor must correctly identify his/her entry by its binomial name or currently accepted scientific designation (*HB*, Chapter 6, Exhibiting in the Horticulture Division).

7. An NGC horticulture entry card **must** accompany each entry and **must** be filled out in advance, if possible, on **both** top and bottom sections. Use a pencil to fill in Section, Class, and Botanical Name or Currently Accepted Scientific Identification. Pencil or waterproof ink may be used to complete rest of card. Computer-generated address labels may be used if waterproof. Refer to *HB* Chapter 6 and p.15 in this Schedule for correctly filled out card.
8. All Horticulture specimens **must** be labeled with the correct binomial name (genus and specific epithet) and/or cultivar, variety or patented/trademarked names. Genus, specific epithet (species) and variety names are underlined when hand-written and *italicized* when mechanically printed (*Horticulture Exhibiting and Judging*, p. 6). Cultivar and common names may be given, but neither is underlined nor italicized. Common names, enclosed in parentheses, can be included below the scientific identification. The genus always begins with a capital letter, and specific epithet (species) and variety with lower case letters. The first letter of the cultivar is capitalized, and cultivar name enclosed in single quotes. Trademarked and registered trademarked plant names are capitalized but not italicized nor put in single quotes.
9. If a plant is considered a flowering plant, it should be exhibited as a flowering specimen. A flowering plant not in bloom **cannot** be entered in a foliage class. Foliage plants may flower but should be exhibited as foliage plants if they are grown primarily for their leaves (*HB*, p. 58).
10. Specimens with a class designation in the schedule may **not** be entered in the 'Any Other Worthy Specimen' class.
11. All horticulture entries **must** first be approved by Horticulture Classification; second, placed by Placement Committee. Horticulture Classification Committee may assist with correct labeling of horticulture entry cards and may disqualify any entry not conforming to the Schedule and/or not of show quality. The Horticulture Classification Chairman and/or General Show Chairman are free to subdivide classes by color, form, size, cultivar, variety, or other distinguishing characteristics, but **there must be 3 or more exhibits, botanically identical (variety, cultivar, series of trademarked name), or similar in form, color, size or description to justify forming a subclass with the exception of petite horticulture specimens which are never in competition with standard-sized specimens but are subdivided into their own class or subclass** (*HB*, p.3, D,2bii). Judges may **not** subdivide but may advise Horticulture Classification to do so. The morning of the judging, the Horticulture Classification Chairman shall count the total number of exhibits in Division I, Horticulture, and give this information to the Judges Chairman who will relay it to the Evaluating Panel.
12. Staging containers for cut specimens, including dwarf/miniature specimens, must be exhibited in clean, transparent green glass bottles (no lettering) appropriately sized to specimen. The Show Committee will supply bottles. **Exception:** The exhibitor shall provide containers for Collections. The use of clear glass marbles or pebbles in the bottom of the bottle is permitted to stabilize a large, cut specimen but cannot be used as wedging.

13. Fruits and Vegetables will be exhibited on white plates with a gold rim and will be furnished by the Show Committee. Section O, Fruits and Vegetables, lists the number of specimens required for each exhibit.
14. Cut specimens for *Hedera* (ivy) and other vines may not exceed 24" from tip of specimen to cut end and may cascade onto tabletop. Specimen should contain several nodes and an apical tip or new growth.
15. Entries of cut specimens may be staged with a small piece of green Styrofoam wedging furnished by the Show Committee.
16. Arboreal specimens must be cut branches and may **not** exceed 30" from the tip of specimen to cut end. Each cut **branch must be at least 12" long** and contain a central leader (the main axis of a branch), several nodes and an apical tip (the tip or growing end of a stem or shoot). **Exception:** Dwarf and/or miniature arboreal specimens must be at least 6" long and contain a central leader, at least two nodes and an apical tip.
17. Plants designated as dwarf/miniature **never** complete with standard-size material and will be exhibited as single specimens in a separate class or subclass.
18. Only members of the Horticulture Placement Committee are permitted to place exhibits. **Exception:** Collections are placed by the exhibitor.
19. **Collections** must be registered in advance with Horticulture Classification Chairman Sandy Reed (404-772-2854; sandyreed17@gmail.com) by September 9, 2023. **Placement of specimens within a Collection is the responsibility of the exhibitor.** Space allowed for each exhibit in Section G (Collections of cut foliage, non-arboreal specimens) is 24" wide x 30" deep with no height restriction. Collection **must** consist of at least five different cut specimens exhibited in individual containers or the appearance of being individually exhibited. Staging containers of transparent, green glass bottles to be furnished by the exhibitor. Staging accessories such as mats, risers, etc., are permitted but must not detract from the specimen; **plant material must dominate.** Each specimen within a Collection **must** be clearly labeled using correct binomial or genus and cultivar names. **The exhibitor must provide a card stating the plant relationships,** and each specimen **must** be identified by its location within the collection. This may be done with a single chart or individual placards. Exhibitor **must** also complete **one** NGC horticulture entry card for each Collection. The Collection constitutes a single entry and only one entry card is used. Specimens within a Collection may consist of a. one family; b. plants with like characteristics; c. different types or species within a genus; d. different cultivars within a genus or specific epithet; e. five different cut annuals, biennials, perennials. Individual specimen scores in the Collection are **NOT** averaged; **the lowest scoring specimen in the Collection will determine the highest ribbon possible for the exhibit.**
20. The Scales of Points for Horticulture are located in the *HB*, Chapter 14, p. 129.

21. The entry cards of all blue ribbon-winning exhibits and Top Exhibitor Award rosettes must be signed and dated by one NGC Accredited Judge on the judging panel. All non-blue ribbon exhibits scoring 90+ points must be designated on the entry card and signed and dated by one NGC Accredited Judge on the judging panel. All other entry cards must be marked with a check by a member of the judging panel to indicate that the exhibit has been judged.
22. All tables in Division I, Horticulture, will be staged in the Courtyard Room at Callanwolde. Tables will be skirted in gray with a white topper bordered with gold dots.

Sample Horticulture Card

Note: Entry Numbers are not used in this Flower Show

National Garden Clubs, Inc.			
<i>Decades of Daisy</i>		9-20-23	
Flower Show		Date	
DIVISION I	SECTION B	CLASS # 7c	ENTRY # NA
<i>Cryptomeria japonica</i>			
VARIETY OR CLASS NAME Dragon Prince™ (Japanese cedar)			
EXHIBITOR Rosemary Bush			
ADDRESS 1 Violet Ln., Lily, GA 30087			
CLUB Magnolia Garden Club			
1 st	2 nd	3 rd	Honorable Mention
EXHIBIT SCORED 90+			

EXHIBITOR Rosemary Bush			
ADDRESS 1 Violet Ln., Lily, GA 30087			
CLUB Magnolia Garden Club			
DIVISION I	SECTION B	CLASS # 7c	ENTRY # NA
<i>Cryptomeria japonica</i>			
VARIETY OR CLASS NAME Dragon Prince™ (Japanese cedar)			



Hort. Classes, Div. I

A Stroll Through Daisy's Garden

Eligible for the NGC Award of Horticultural Excellence

SECTION A. SHRUBS - *Sculptural Forms* (2008)

Eligible for the NGC Arboreal Award

Arboreal specimens **must** be cut branches and may not exceed 30" in length. Each branch **must** be at least 12" long and contain a central leader (the main axis of a branch), several nodes and an apical tip (the tip or growing end of a stem or shoot). Dwarf/Miniature specimens **must** be at least 6" long and contain a central leader, several nodes and an apical tip. Refer to Schedule Horticulture Rule #16, p. 14. **If a shrub is grown primarily for its bloom, the specimen must be in bloom.** If it is **not** in bloom, it may **not** be exhibited in any other shrub class or subclass.

Class 1. Flowering

- a. *Abelia*
- b. *Buddleia* (butterfly bush)
- c. *Camellia*
- d. *Gardenia*
- e. *Hydrangea*
 1. *Hydrangea macrophylla*
 - a. lacecap
 - b. mophead
 2. *Hydrangea paniculata*
 3. *Hydrangea serrata*
 4. Any other worthy named *Hydrangea*
- f. *Rhododendron* (includes azaleas)
- g. *Viburnum*
- h. Any other worthy named flowering shrub other than *Hydrangea*

Class 2. Berried/Fruited

- a. *Berberis* (barberry)
- b. *Callicarpa* (beautyberry)
- c. *Ilex* (holly)
- d. Any other worthy named berried/fruited shrub

Class 3. Broadleaf Evergreen

- a. *Aucuba japonica*
- b. *Buxus* (boxwood)

- c. *Fatsyhedera*
- d. *Fatsia*
- e. *Illicium* (anise)
- f. *Loropetalum* (fringe flower)
- g. *Osmanthus*
- h. *Pittosporum*
- i. Any other worthy named broadleaf evergreen shrub

Class 4. Needled Evergreens (coniferous)

- a. *Cephalotaxus* (plum yew)
- b. *Juniperus* (juniper)
- c. *Podocarpus*
- d. Any other worthy named needled evergreen shrub

SECTION B. TREES - *Stewards of the Garden* (1994)

Eligible for the NGC Arboreal Award

Arboreal specimens **must** be cut branches and may not exceed 30” in length. Each branch **must** be at least 12” long and contain a central leader (the main axis of a branch), several nodes and an apical tip (the tip or growing end of a stem or shoot). Dwarf/Miniature specimens **must** be at least 6” long and contain a central leader, several nodes and an apical tip. Refer to Horticulture Schedule rule #16, p. 14. **If a tree is grown primarily for its bloom, the specimen must be in bloom**, and may **not** be exhibited in any other tree class or subclass.

Class 5. Broadleaf Evergreen

- a. *Eucalyptus*
- b. *Magnolia*
- c. *Olea europaea* (olive)
- d. Any other worthy named broadleaf evergreen tree

Class 6. Deciduous

- a. *Acer palmatum* (Japanese maple)
- b. *Ginkgo*
- c. *Lagerstroemia* (crepe myrtle)
- d. Any other worthy named deciduous tree

Class 7. Needled Evergreen (coniferous)

- a. *Cedar*
- b. *Cephalotaxus* (plum yew)
- c. *Cryptomeria japonica* (Japanese cedar)
- d. Cypress
 - 1. *Cupressocyparis x leylandii* (Leyland cypress)
 - 2. *Cupressus*
- e. *Pinus* (pine)
- f. *Thuja* (arborvitae)
- g. Any other worthy named needled evergreen tree

SECTION C. FERNS (true ferns) – *Airy Elegance* (2012)

Eligible for the NGC Award of Merit

- Class 8. *Adiantum* (maidenhair)
- Class 9. *Asplenium* (bird's nest)
- Class 10. *Athyrium* (lady)
- Class 11. *Crytomium* (holly)
- Class 12. *Dryopteris* (wood, autumn)
- Class 13. *Matteuccia* (ostrich)
- Class 14. *Nephrolepis* (Boston)
- Class 15. *Osmandastrum* (cinnamon)
- Class 16. *Poystichum* (Christmas, sword)
- Class 17. Any other worthy named true fern

SECTION D. HOSTA – *Glorious Greens* (2022)

Eligible for the NGC Award of Merit

Exhibited as leaf only – no bloom

- Class 18. Small leaf (up to 3 inches across)
- Class 19. Medium leaf (3 to 6 inches across)
- Class 20. Large leaf (6 to 8 inches across)
- Class 21. Extra-large leaf (over 8 inches across)

SECTION E. HEDERA (ivy) - *Art in Motion* (2008)

Not to exceed 24” in length and may cascade onto tabletop; apical bud or new growth must be present. English ivy is the common name for *Hedera helix*.

- Class 22. *Hedera helix* – bird’s foot
- Class 23. *Hedera helix* – curly/crested
- Class 24. *Hedera helix* – fan-shaped
- Class 25. *Hedera helix* – heart-shaped
- Class 26. *Hedera helix* – ivy-ivies
- Class 27. *Hedera helix* – miniature
- Class 28. *Hedera helix* – variegated
- Class 29. Any other worthy named species, other than *Hedera helix*

SECTION F. ROSA (rose) - *Absolute Elegance* (1995)

Eligible for the NGC Award of Merit

- Class 30. Hybrid Tea
- Class 31. Miniature
- Class 32. Shrub
- Class 33. Any other worthy named rose

SECTION G. COLLECTIONS, CUT FOLIAGE SPECIMENS – *Together We Stand* (2002)

Eligible for the NGC Collector’s Showcase Award

non-arboreal

Pre-registration required with Horticulture Classification Chairman, Sandy Reed, (404-772-2854; sandyreed17@gmail.com). **Must** consist of at least 5 different cut specimens. Space allowed each exhibit is 24” wide x 30” deep, no height restriction. Staging containers **must** be compatible and

furnished by exhibitor. Exhibitor **must** label each specimen with the correct genus, specific epithet, cultivar and identify location of each specimen, and **note the plant relationships** (i.e., annuals, hostas, etc.). Read Schedule Horticulture Rule #19, p. 14. Each class judged on its own merit.

Class 34. Ferns, true

Class 35. Herbs

Class 36. *Hosta*

Class 37. Any other worthy named cut foliage collection

SECTION H. FLOWERING ANNUALS – *A Tapestry of Color* (2007)

Eligible for the NGC Award of Merit

Class 38. *Begonia*

Class 39. *Celosia* (exhibit with at least 3 leaves)

Class 40. *Lantana*

Class 41. *Pentas*

Class 42. *Tagetes* (marigold) (exhibit with at least 3 leaves)

Class 43. *Zinnia* (exhibit large or medium blooms with at least 2 sets of leaves, and small with at least 1 set of leaves)

Class 44. Any other worthy named flowering annual

SECTION I. FOLIAGE ANNUALS – *A Fusion of Green* (1995)

Eligible for the NGC Award of Merit

Class 45. *Ipomoea batatas* (ornamental sweet potato vine)

Class 46. *Plectranthus scutellarioides* (coleus) (exhibit with at least 2 sets of leaves)

Class 47. *Strobilanthes dyeranus* (Persian shield)

Class 48. Any other worthy named foliage annual

SECTION J. FLOWERING PERENNIALS – *Repeat Performance* (1998)

Eligible for the NGC Award of Merit

Class 49. *Gerbera*

Class 50. *Leucanthemum* (Shasta daisy)

Class 51. *Physostegia* (obedient plant)

Class 52. *Rudbeckia*

Class 53. *Salvia*

Class 54. *Sedum* ('Autumn Joy' [*Hylotelephium spectabile*], for example)

Class 55. Any other worthy named flowering perennial, except *Achillea* (yarrow) and *Echinacea* (coneflower) which are exhibited in Section N

SECTION K. FOLIAGE PERENNIALS – *I Want You Back* (2014)

Class 56. *Aspidistra*

Class 57. *Begonia* (grown for foliage; *rex* for example)

Class 58. *Cyperus*

Class 59. *Polygonatum* (Solomon's seal)

Class 60. *Setcreasea* (purple heart)

Class 61. *Stachys* (lamb's ear)

Class 62. Any other worthy named foliage perennial, except herbs, true ferns, *Hedera* and *Hosta* which are exhibited in Sections N, C, E or D

SECTION L. FLOWERING BULBS, CORMS, TUBERS, RHIZOMES –

Eligible for the NGC Award of Merit

Picturesque Performers (2012)

Class 63. *Canna* (may be exhibited as a flower on the stalk with or without leaf attached)

Class 64. *Dahlia* (a single, disbudded bloom with one set of leaves is required)

Class 65. *Lycoris* (spider lily)

Class 66. Any other worthy named flowering bulb, corm, tuber or rhizome

SECTION M. FOLIAGE BULBS, CORMS, TUBERS, RHIZOMES-*Sleeping Beauty*

Eligible for the NGC Award of Merit

(2017)

Class 67. *Asparagus* fern

a. *Asparagus densiflorus* (foxtail)

b. *Asparagus setaceus* (plumosa)

c. *Asparagus sprengeri*

Class 68. *Caladium*

Class 69. *Colocasia* (elephant ear)

Class 70. Any other worthy named foliage bulb, corm, tuber or rhizome

SECTION N. HERBS - *Savory Delights* (1988)

Class 71. Aromatic/Decorative

a. *Achillea* (yarrow)

b. *Artemisia* (wormwood)

c. *Lavandula* (lavender)

d. Any other worthy named aromatic/decorative herb

Class 72. Culinary

a. *Mentha* (mint)

b. *Ocimum basilicum* (basil)

c. *Rosmarinus* (rosemary)

d. Any other worthy named culinary herb

Class 73. Medicinal

a. *Allium* (garlic)

b. *Asarum* (wild ginger)

c. *Echinacea* (coneflower)

d. Any other worthy named medicinal herb

SECTION O. FRUITS AND VEGETABLES, edible produce - *Victory Garden* (2022)

Eligible for the NGC Award of Merit

Fruits and vegetables will be exhibited on white plates with a gold rim furnished by the Show Committee.

Class 74. *Abelmoschus esculentus* (okra)

a. 1 large with stem

b. 5 small with stem

Class 75. *Capsicum annuum* (pepper)

- a. 1 large with stem b. 5 small with stem

Class 76. *Solanum lycopersicum* (tomato)

- a. 1 large, no stem, exhibited with stem side down b. 5 small with stem

Class 77. Any other worthy named fruit or vegetable



Design Rules, Division II

1. The Design Division is open to members of an organized Garden Club, Judges' Study Club or Council that is a member of GCG. **Exception:** All Student Exhibitors who have successfully completed two courses of Flower Show School, Student Judges who have completed three courses of Flower Show School, all levels of Accredited Judges needing exhibiting credit and Subscribing Members of GCG are invited to enter a design.
2. Advance reservations for entries in Division II, Design, Sections A, B and C **must** be made with Design Entries Chairman, Diane Hunter (drmchunter@yahoo.com;404-992-7381), by August 28, 2023.
3. All designs in Division II will be staged in the Courtyard Room at Callanwolde. Designs may be entered on Tuesday, September 19, 2023 in the Courtyard Room between the hours of **1:00 p.m. and 6:00 p.m.** and Wednesday, September 20, 2023 between 8:00 a.m. and 9:00 a.m. **Designs must be ready for judging by 9:00 a.m. Wednesday, September 20, 2023.**
4. The Show Committee will furnish all staging unless otherwise stated in a particular class.
5. The NGC exhibit policies are printed in the *HB*, Chapter 7, pp. 70-81, Exhibiting in the Design Division, NGC Policies and Guidelines.
6. If the designer is unable to fulfill the design assignment, it is the designer's responsibility to provide a substitute and inform the Entries Chairman prior to the day of the show.
7. The exhibit entered into competition must be the work of only one exhibitor, and that exhibitor's name must appear on the entry card provided by the Show Committee.
8. Designer is on his/her honor that the design being entered has not been previously exhibited in a flower show or any other venue for judging and point scoring by the NGC Standard System of Awarding.

9. An exhibitor may enter multiple classes within the Design Division but only one exhibit per class. There will be four entries in each class.
10. If the designer is unavailable to transport and/or set up his/her design, a substitute person may enter the exhibit for the designer. The designer may still receive exhibiting credit if needed. This is permitted only for completed designs.
11. To educate the public, plant material used in the design must be identified on the 3" x 7" entry card provided by the Show Committee. Botanical and/or common names acceptable.
12. The exhibitor is required to conform to the stated descriptions and limitations of the Design Type if named in the class.
13. Designer has the freedom to choose Traditional or Creative style with any design listed unless restricted by the Schedule.
14. Rules for Design Types, Advanced Design Types, Table Designs and table appointments are printed in the *HB*, Chapter 7, pp. 73-79.
15. Some plant material **must** be used in every exhibit. This includes fresh and/or dried plant material. Fresh plant material may **not** ever be treated in any manner in this show. Dried plant material may be treated.
16. A single flower is **not** a design. Container-grown plants are fresh plant material and are permitted in the Design Division where appropriate, but they are never considered floral designs.
17. Landscapes, scenes or anything representing an actual item of clothing, person, animal, etc., are not considered acceptable in the Design Division.
18. Religious symbols used in a design must be displayed in a respectful manner.
19. Plant material in the Design Division need not have been grown by the designer unless the Schedule requires it in a specific section/s or classes.
20. Plant material and non-plant material permitted and not permitted in the Design Division are printed in the *HB*, Chapter 7, pp. 80-81.
21. The following plant material is **permitted** in the Design Division:
 - a. Products manufactured from plant material whose natural state (leaves, branch, tree trunk, root, etc.) has been so altered as to be given a new identity and a specific name, such as rope, basket, mat, etc.
 - b. **Decorative wood** (weathered wood) (**Exception: not permitted** in Tricolor classes)
 - c. Altering the appearance of dried plant material.
 - d. Using absorbing solutions such as glycerin, bleach, anti-freeze, etc., on fresh plant material to change the natural dried state.

- e. **Contrived plant material** (a new form constructed of fresh and/or dried plant material appearing as an obvious “fantasy” floral form, foliage or stem).
 - f. Dried man-made constructed components retaining their recognizable character as plant material (and not used as a container), such as grapevine forms, etc., are considered dried plant material.
 - g. Living plants with roots attached, such as moss, Bromeliaceae family members or container-grown specimens.
 - h. Fresh fruits, vegetables and non-perishable food products. Whole fruits and vegetables are allowed. All cut fruits and vegetables must be sealed with an unobtrusive substance.
22. Plant material **not permitted** in the Design Division:
- a. Painting, flocking, glittering or dyeing of fresh plant material in any manner. (All other physical embellishments of fresh plant material are permitted.)
 - b. Artificial flowers, foliage, fruits and vegetables. (Artificial defined as “imitation” or a “copy,” handcrafted or manufactured to represent and/or appear as real plant material.)
 - c. Silk, plastic, or other imitation plant material.
 - d. Manufactured items simulating plant material. (Examples: singing/speaking flowers, motorized flowers and metallic flowers and foliage, fountains featuring metal cattails and/or waterlilies).
23. Non-plant material **permitted** in the Design Division:
- a. **Accessories** (a subordinate object other than plant material) and **featured objects** (an object that is dominant in a design).
 - b. Dinnerware, inspired in design by the form of a plant (flower, fruit, leaf, vegetable, etc.) created **not** to replace the actual plant material, but to serve as an interesting piece of dinnerware (cabbage-shaped tureen, apple-shaped luncheon plate, floral-motif napkin ring). A traditional container with three-dimensional motif is essentially a container.
 - c. Objects adding interest when permitted by federal, state and/or local regulations, such as feathers, antlers, coral, horns, starfish, sponges, sea fans, nests or manufactured or crafted simulations of birds, animals, etc.
 - d. Special lighting not requiring an electrical source.
 - e. All staging properties, such as panels, including staging panels, frames, pedestals, columns, boxes, cubes, underlays, etc.
24. Non-plant material **not permitted** in the Design Division:
- a. American and other national flags
 - b. Living members of the animal kingdom and/or taxidermal representations
25. Exhibitors may seek advice or information from the Design Consultant listed with each Design Section. The Design Consultant must check each exhibit after it has been placed by the exhibitor and place an entry card with the design before the exhibitor leaves the floor.
26. Exhibitors are responsible for keeping plant material in fresh condition throughout the duration of the show.

27. The entry cards of all blue ribbon-winning exhibits and Top Exhibitor Award Rosettes in Division II, Design, must be signed and dated by one NGC Accredited Judge on the judging panel. All non-blue-ribbon exhibits scoring 90+ points must be designated on the entry card, which must be signed and dated by one NGC Accredited Judge on the judging panel. All other Design Division entry cards must be marked with a check by a member of the judging panel to indicate that the exhibit has been judged.
28. Judges are requested to leave written comments on all exhibits in Division II, Design, Sections A, B and C. Blue ribbons are to be the only recognition of qualifying for NGC Top Exhibitor Awards prior to final judging. In sections where NGC Top Exhibitor Awards have been placed, only those winners are eligible for consideration from those sections for the Award of Design Excellence. The exact scores and/or 95+ must not be written on the blue ribbon-winning entry cards until section and division judging is completed and all competitive awards have been placed.
29. Judges are asked to remain in the Great Hall until all top awards have been placed.

Scale of Points for All Designs

Conformance		14
To Design Type* (if applicable)	7	
To Schedule Requirements	7	
Design Principles	(each 8)	48
Selection of Components		8
Organization of Components		8
Expression (Interpretation of class title/theme)		8
Distinction (Marked superiority in technique & craftsmanship; exceptional qualities, condition of plant material, mechanics)		<u>14</u>
TOTAL		100

*When a design type has been specified, its value will be 7 points for conformance. The remaining 7 points will be divided equally among the remaining requirements. If no design type is specified, points allocated to this quality are divided equally among the requirements stated in the class description.



Design Classes, Div. II

Expressions of Daisy

Eligible for the NGC Award of Design Excellence

Section A. *Daisy Dances 'Round the World* (2006)

Eligible for the NGC Petite Award

Section A design classes will be staged in an off-white cabinet 48" wide x 12" deep x 40" high, with each class on an individual shelf illuminated by white lights. Cabinet is affixed to an off-white base 48" wide x 12" deep x 37" high. Exhibitor has complete freedom to choose plant material and other components. A medium gray background and underlay will be provided by the Show Committee, and no other staging panel or underlay is permitted. No electrical access is available in this section. Plant material must be listed in the allotted space on the front of the entry card.

Class 1. *Two - Step* (2006)

Four **Petite Designs, Creative or Traditional**, each 9" high, staged in a space 10" wide x 10" deep x 10" high on the top shelf of the off-white cabinet described above. Design may not exceed 9" in height, width or depth.

Class 2. *Square Dance* (2006)

Four **Petite Designs, Creative or Traditional**, each 8" high, staged in a space 10" wide x 10" deep x 10" high on the middle shelf of the off-white cabinet described above. Design may not exceed 8" in height, width or depth.

Class 3. *The Twist* (2006)

Four **Petite Designs, Creative or Traditional**, each 7" high, staged in a space 10" wide x 10" deep x 10" high on the bottom shelf of the off-white cabinet described above. Design may not exceed 7" in height, width or depth.

Design Consultant: Dian Goldwire, c. 706-957-4217, dgoldwire813@gmail.com

Expressions of Daisy

Eligible for the NGC Award of Design Excellence

Section B. *Daisy Through the Looking Glass* (2013)

Eligible for the NGC Designers Choice Award

Exhibitor has complete freedom to choose plant material and other components. Designer is free to incorporate staging properties. All properties, unless otherwise noted, will be provided by the Show Committee. No electrical access. Plant material must be listed in the allotted space on the front of the entry card.

Class 4. *Curiouser and Curiouser* (2013)

Four **Floor Designs**, each staged on the floor using a space 40” square with no height restriction. Designs are freestanding and may be viewed from all around, but will be judged from the front, as determined by placement of the entry card.

Class 5. *Mad Hatter’s Tea Party* (2013)

Four **Exhibition Tables**, each staged using a 40” high off-white pedestal with an 18” square top and placed in a floor space 24” square with no height restriction. Underlay permitted if furnished by exhibitor but may not extend beyond top surface of pedestal. Other components may extend beyond and downward from top surface of pedestal.

Class 6. *Hall of Mirrors* (2013)

Four **Reflective Designs** with two exhibits using a 30” high table with brown legs and a moss green triangular top 20” x 20” x 28” and two exhibits each using a 30” high table with brown legs and a moss green triangular top 23” x 23” x 33”. Each design is staged in front of a pair of center hinged, honey-colored doors, each 30” wide x 82” high. Maximum overall floor space for each exhibit is a triangular space of 30” x 30” x 41” with height not exceeding the 82” height of the doors. The windows of the doors will be backed with shiny silver paper. Underlay permitted if furnished by exhibitor but may not extend beyond edge of table. Photo of table and doors available from Staging Chairman upon request.

Design Consultant: Bettye Trankina, h.770-410-5819, c.770-508-5222, bhtrankina@gmail.com

Expressions of Daisy

Eligible for the NGC Award of Design Excellence

Section C. *Daisy Digs Art* (2008)

Eligible for the NGC Designer's Choice Award

Exhibitor has complete freedom to choose plant material and other components. All properties, unless otherwise noted, will be provided by the Show Committee. No electrical access available in this section. Plant material must be listed in the allotted space on the front of the 3" x 7" entry card.

Class 7. *Monet's Garden* (2008)

Four **Traditional Mass Designs**, each staged using a 40" high off-white pedestal with a 15 3/8" square top placed in a floor space 28" square with no height restriction. Underlay permitted if furnished by exhibitor but may not extend beyond top surface of pedestal.

Class 8. *Meet the Artist* (2008)

Four **Functional** informal **Tables** for one, each staged using a silver-colored table 21" in diameter and 28 1/4" high placed in a space 36" square with no height restriction. Photo of table available from Staging Chairman upon request. A decorative unit (floral design) must be included. Underlay or tablecloth permitted if provided by exhibitor.

Class 9. *Picture Perfect* (2008)

Four **Traditional or Creative Designs**, each staged using an off-white block 28" wide x 28" deep x 30" high placed in a floor space 40" square with no height restriction. Exhibitor to furnish a piece of artwork, sculpture or art object and interpret the artist's work with a design. Artwork to be displayed upright. Artwork and design to be exhibited together on the off-white block. Underlay permitted if furnished by exhibitor but may not extend beyond top surface of block.

Class 10. *Picasso's Cube* (2008)

Four **Creative Designs**, each staged using an off-white shadow box 30 1/8" wide x 17 3/4" deep x 30" high placed on an off white 30" cube in front of windows with sheer white draperies. Design to be viewed through an irregularly shaped opening approximately 18"-20" square. Interior of shadow box is black and illuminated with clear lights. Design not to exceed interior dimensions of shadow box (30" wide x 17 1/2" deep x 30" high).

Design Consultant: Janet McGinnis, h.770-939-8878, c.404-326-0530, jmcgi@bellsouth.net



Education Rules, Div. III

1. The Education Division is open to members of an organized Garden Club, Judges' Study Club or Council that is a member of GCG. **Exception:** All Student Exhibitors who have successfully completed two courses of Flower Show School, Student Judges who have completed three courses of Flower Show School, all levels of Accredited Judges needing exhibiting credit, and Subscribing Members of GCG are invited to enter an educational exhibit.
2. Advance reservations for entries in Division III, Education, **must** be made with the Education Entries Chairman/Consultant, Gale Thomas (galedthomas@gmail.com; c.404-735-8027) by September 9, 2023.
3. Education exhibits may be the work of more than one individual or organization unless a Student Judge or an Accredited Judge is seeking exhibiting credit for preparing an education exhibit.
4. An education exhibit **must** occupy a minimum of 18 square feet of surface area to qualify for the Top Educational Award.
5. There will be one entry for each of the three competitive exhibits.
6. Exhibitors are encouraged to read the *HB*, Chapter 8, pp. 85-86.
7. Exhibitors are encouraged, but not required, to use some plant material in their exhibits. Depending on the subject matter of the exhibit, plant material may not be suitable. If plant material is used, it must be listed on the 3"x7" entry card provided by the Show Committee.
8. The use of fresh fruits, vegetables and non-perishable food products is permitted. The use of whole fruits and vegetables is allowed. All cut fruits and vegetables must be sealed with an unobtrusive substance (such as saran wrap).
9. The use of artificial plant material is **not** permitted.
10. Educational exhibits will be staged in the Dining Room at Callanwolde. Each exhibit will be staged against a cream colored wall in a space not to exceed 6' wide x 30" deep, with no height restriction. Innovative staging is encouraged with the option of a 6' wide x 30" deep x 30" high table covered in gray cloth and provided by the Show Committee. Exhibitor has the option to request from Show Committee a white topper bordered with gold dots. Underlay permitted if furnished by exhibitor and may extend beyond edge of table.

11. The Education Consultant must check each exhibit after it has been placed by the exhibitor and place an entry card with the exhibit before the exhibitor leaves the floor.
12. Judges are asked to leave written comments on all exhibits in Division III, Education, Class 1, Exhibits 1, 2 and 3.
13. **Entry cards of blue ribbon-winning exhibits and NGC Educational Award Rosette in Division III, Education, must be signed and dated by one NGC Accredited Judge on the judging panel. All non-blue ribbon exhibits scoring 90+ points must be designated on the entry card, which must be signed and dated by one NGC Accredited Judge on the judging panel.**

Division III, Education Scale of Points

Educational Value		60
Interest to viewer	25	
Clear, concise presentation	15	
Adequate signage	10	
Conforms to NGC objectives	10	
Staging		20
Craftsmanship/technique	10	
Distinction	10	
Creativity and Expression		<u>20</u>
	TOTAL	100



Education Exhibits, Div. III

Daisy's in the Know

Eligible for the NGC Educational Award

Section A. *Daisy Delights in Show and Tell* (1988)

Class 1. *A Pocketful of Wisdom* (1980)

Exhibit 1. *Daisy Tells Her Story* (1974)

The Yellow Daisy Flower Show Story

Exhibit 2. *Flights of Fancy* (1999)

Protecting Our Pollinators

Exhibit 3. *Going Green Daisy Style* (2010)

Saving the Planet

Gale Thomas, Education Chairman, c. 404-790-7101; galedthomas@gmail.com



Youth Rules, Div. IV, Sec. A

Daisy Through the Ages

1. Division IV, Youth Design, Section A is open to youth pre-school through eighteen years of age. Youth may participate as an individual or as a member of an organized group. Age categories: Juniors: Pre-school through age 7; Intermediates: ages 8 through 12; and High School: ages 13 through 18.
2. Advance reservations for entries in Division IV, Youth Design, **must** be made with the Youth Entries Chairman/Consultant, Susan Turner (glencree@bellsouth.net; 770-922-4411) by September 10, 2023.
3. Section A, Youth Design, will be staged in the Dining Room in front of windows on a dark wood oval table 110” L x 58” W x 31” H covered with a gray cloth and a white topper bordered with gold dots. Each design in Classes 1 – 3 will be staged on the aforementioned table in a space not to exceed 12” square with no height restriction.
4. Exhibitor to list plant material on the 3” x 7” entry card provided by the Show Committee. Botanical names not required. Common names acceptable.
5. Each design in Section A, Youth Design, must be created solely by the individual exhibitor.
6. Youth exhibits are evaluated using the adult Design Scale of Points (*HB*, pp. 129-130). Adult rules in the Design Division (pp. 21-24 in this Schedule) are to be followed where applicable. **Exception:** Youth exhibits require a score of 90 instead of 95 to be eligible for an NGC Youth Top Exhibitor Award.
7. NGC Exhibit Policies are printed in the *HB*, Chapter 9, Exhibiting in the Youth/Sponsored Groups Division, NGC Policies and Guidelines.
8. **Age must be stated on the 3”x7” entry card** furnished by the Show Committee.
9. Some plant material **must** be used in each design, and it may be dried, treated dried and/or fresh. Fresh plant material is **never** allowed to be treated, but it may be clipped, stripped, or otherwise manipulated. Only dried plant material may be treated or painted.
10. Youth exhibits will be staged by the Youth Chairmen according to Juniors, Intermediates and High School categories, and then sub-divided according to the age listed on the entry

card, allowing judges to award one blue, one red, one yellow and white ribbons as merited, in each age subdivision. Youth Chair may further subdivide ages by design characteristics.

11. **Judges are asked to leave written comments on all exhibits in Division IV, Youth Design, Section A.**
12. **The entry cards of all blue ribbon-winning exhibits and NGC Youth Top Exhibitor Award Rosettes in Division IV, Youth Design, Section A, must be signed by one Accredited Judge on the judging panel. All other Youth entry cards must be marked with a check to indicate that the exhibit has been judged.**



Section A. *Ring the School Bell* (1989)
Eligible for the NGC Youth Award

A total of 3 NGC Top Youth Awards may be awarded in the Youth Design Division, Section A, if merited. Winning exhibits must be the highest scoring blue-ribbon exhibits and score 90 or above. One award may be given in each of the following age categories:

Juniors: pre-school through age 7
Intermediates: ages 8 through 12
High School: ages 13 through 18

Class 1. *Art Class* (Juniors) (1992)

Create a **Design** incorporating something you may use or find in an art class.

Class 2. *Sounds of Music* (Intermediates) (1985)

Create a **Design** interpreting a favorite song, instrument or anything music related.

Class 3. *Geometry* (High School)

Create a **Design** relating lines, angles and/or shapes.

Susan Turner, Youth Chairman, h. 770-922-4411, c. 404-502-8147; glencree@bellsouth.net
Melodie Janin, Youth Co-Chairman, c. 678-633-0219; melodiejanin@yahoo.com



Sponsored Groups Rules, Sec. B

Division IV

1. Youth and Sponsored Groups do not compete against each other.
2. Entries in Division IV, Section B, Sponsored Groups, are limited to members at the Olivia Haydel Senior Center in Conyers.
3. Advance reservations for entries in Division IV, Section B, Sponsored Groups Design, may be made with Sponsored Groups Chairman, Gale Thomas (galedthomas@gmail.com; 404-790-7101).
4. Exhibits are judged by the NGC Standard System of Awarding using the Standard Scale of Points (Scale of Points on p. 31 in this schedule). **No** NGC Top Exhibitor Awards may be offered, but sponsoring organization awards will be offered and require a score of 90 or above to be eligible. Judges must consider the ages and abilities of exhibitors when evaluating the exhibits.
5. Section B, Sponsored Group Designs, will be staged in the Dining Room at Callanwolde against a cream-colored wall on a table 6'L x 30" D x 30" H covered with a gray cloth and a white topper bordered with gold dots. Each design will be placed in a space not to exceed 12" square with no height restriction.
6. Exhibitor is to list plant material on the 3"x7" entry card provided by the Show Committee. Botanical names are not required, Common names acceptable.
7. Each design in Section B, Design, must be created solely by the individual exhibitor.
8. Some plant material must be used in each design, and it may be dried, treated dried and/or fresh. Fresh plant material is never allowed to be treated, but it may be clipped, stripped, or otherwise manipulated. Only dried plant material may be treated or painted.
9. The NGC Exhibit Policies are printed in the *HB*, Chapter 9, exhibiting in the Youth and Sponsored Groups Division, NGC Policies and Guidelines.
10. **Judges are asked to leave written comments on all exhibits in Division IV, Sponsored Group Design, Section B.**
11. **The entry cards of all blue ribbon-winning exhibits in Division IV, Sponsored Group Design, Section B, must be signed by one Accredited Judge on the judging panel. All other Sponsored Group entry cards must be marked with a check by a member of the judging panel to indicate that the exhibit has been judged.**



Sponsored Groups Classes, Sec. B

Division IV

Daisy Through the Ages

Section B. *Time Flies* (1977)

Eligible for the Best in Class Sponsored Group Design Award

A total of 3 Best in Class Sponsored Group Awards may be awarded in the Sponsored Group Division IV, Design, Section B, if merited. Winning exhibits must be the highest scoring blue-ribbon exhibits and score 90 or above. One award may be given in Class 4, one in Class 5 and one in Class 6.

Class 4. *Fun Times* (1979)

Reflecting on your youth, think of fun games that remind you of times past (jump rope, jacks, etc.) and create a **Design** incorporating items depicting that game. Exhibitor designs at back of table may be elevated on books wrapped in brown butcher paper provided by the Show Committee.

Class 5. *Footloose and Fancy Free* (1975)

Create a **Design** using some type of footwear or representation of (shoe, boot, etc.). Design (including footwear) not to exceed 12" square with no height restriction. For better visibility, designs placed at the back of the table may be elevated on a dark gray shoe box provided by the Show Committee.

Class 6. *Hands of Time* (1977)

Create a **Design** incorporating a time piece or clock parts. Some designs may be elevated on clear lucite cubes 3", 4" or 5" furnished by the Show Committee.

Floor Plan

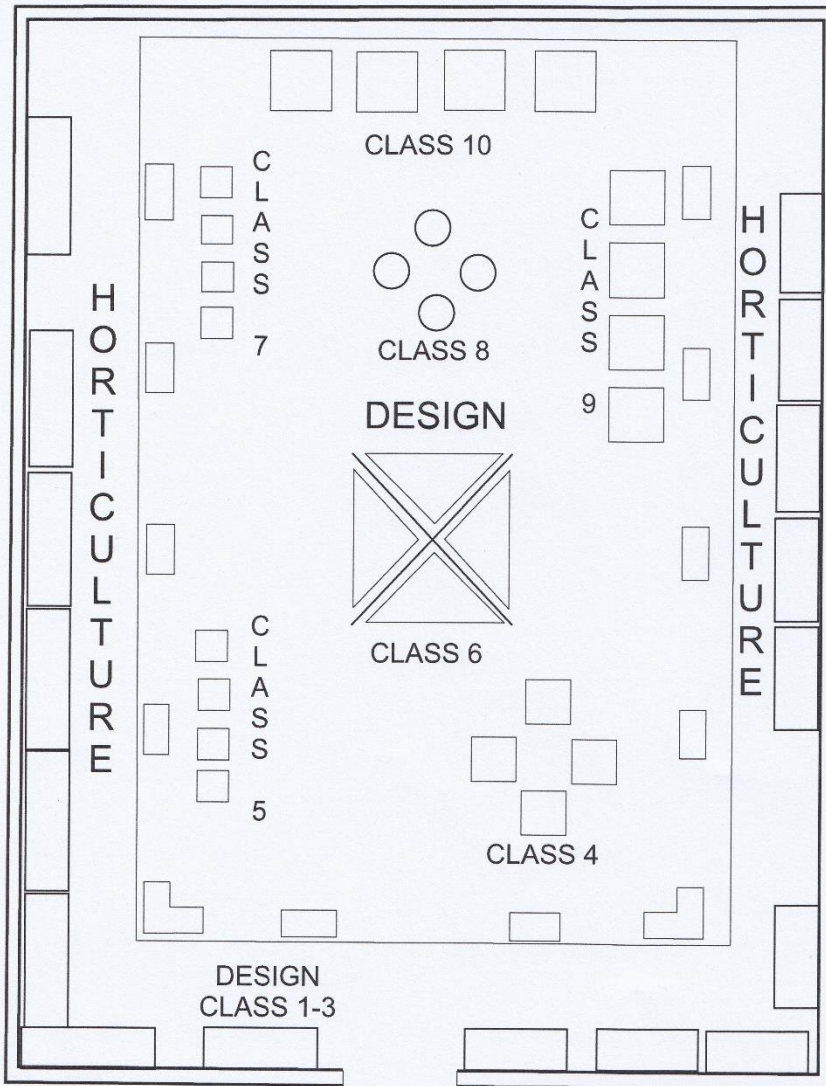

← The Courtyard Room

↓ The Dining Room

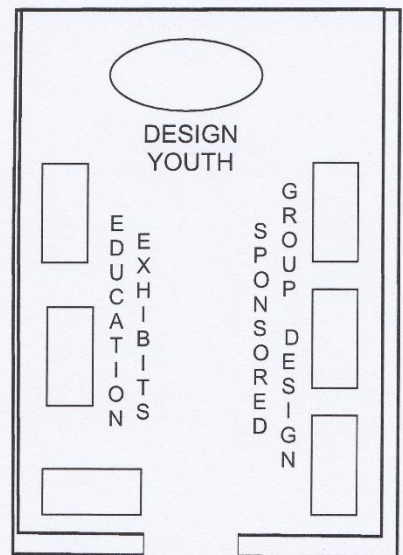



Note of Appreciation

*Our deepest appreciation and gratitude
To Callanwolde Fine Arts Center
For their generosity in allowing
Redbud District use of their historic venue.*

*A special thanks to
The Flower Show Committee,
Flower Show Judges, Clubs and
Show participants whose
Cooperation, patience and
Efforts contributed to the success of....*

*Redbud District's 50th Flower Show
"Decades of Daisy"*